

**BILL OF MATERIAL**

QTY.	MARK	DESCRIPTION	LENGTH	REMARKS	LINE
556	1AB1	3/4" $\phi$ ANCHOR ROD W/ (3) HEAVY HEX NUT + WASHER	1'-2"	F154-0551	1
556	1a0	PL 3/8X3	0'-3"	A36	2
104	1AB2	1" $\phi$ ANCHOR ROD W/ (3) HEAVY HEX NUT + WASHER	1'-9"	F154-0551	5
104	1a0	PL 3/8X3	0'-3"	A36	6
64	1AB3	3/4" $\phi$ HEADED ANCHOR BOLT W/ ONE HEAVY HEX NUT + WASHER	0'-10 1/2"	F154-0551	9
					8
					10
					11
48	1AB4	3/4" $\phi$ ANCHOR BOLT W/ ONE HEAVY HEX NUT + WASHER	1'-4 1/2"	F154-0551	12
					13
					14
184	1AB5	3/4" $\phi$ HEADED ANCHOR BOLT W/ ONE HEAVY HEX NUT + WASHER	1'-2"	F154-0551	15
					16
					17
					18
					19
					20
					21
					22
					23
					24
					25
					26
					27
					28
					29
					30
					31
					32
					33
					34
					35
					36
					37
					38
					39
					40
					41
					42
					43

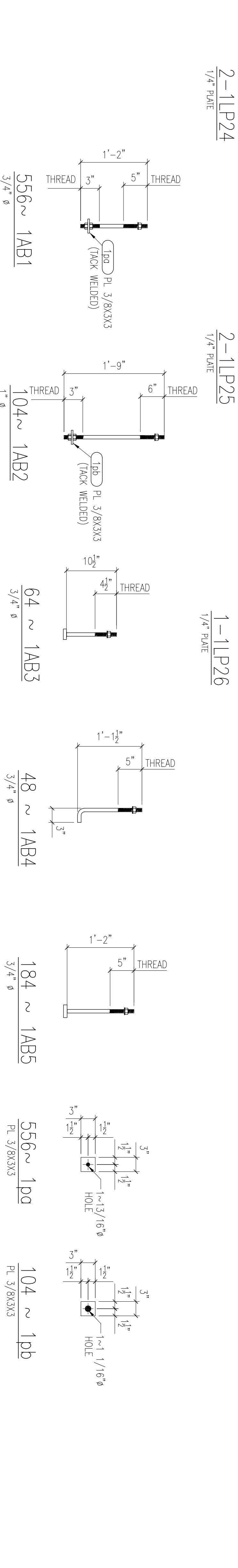
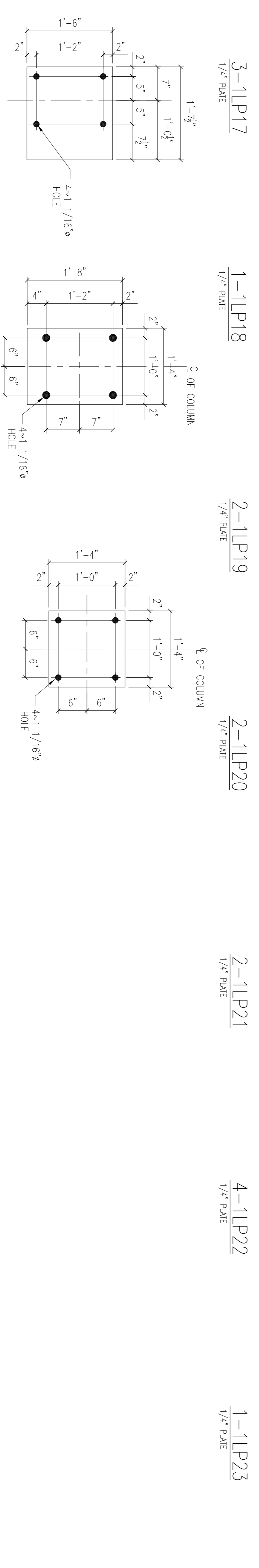
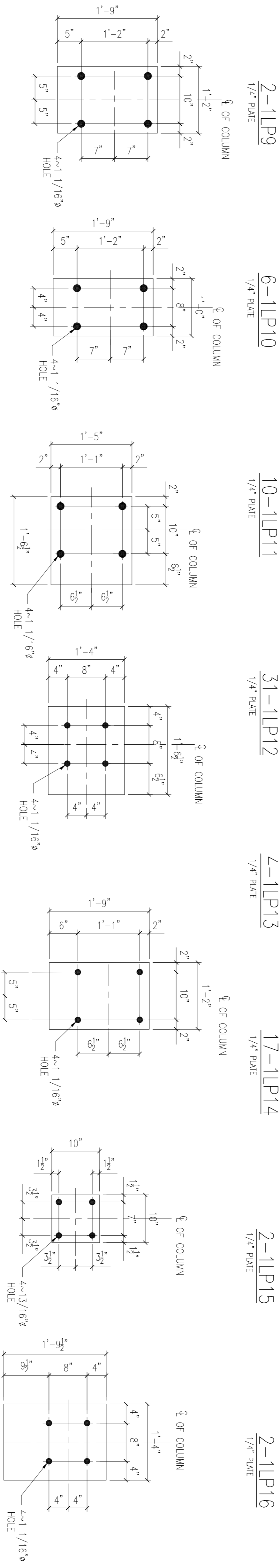
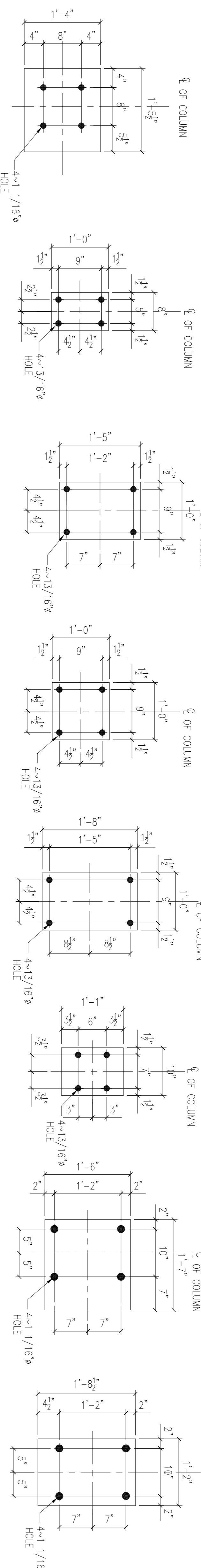
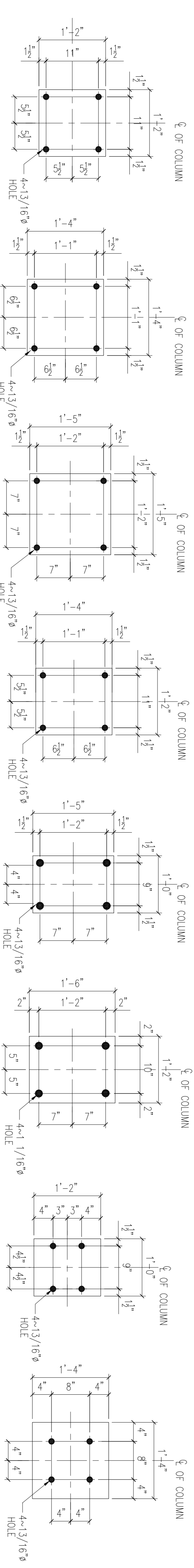

**Harbee Structures Private Limited**  
www.ordbsteelindia.com

Job Name			
Location			
Customer			
Eng. or Arch.			
Contents			
Del. by:	Date:	Chkd. by:	Date:
Notes:	Bolts:		
REV. DMC:	Shop Point:		
		JOB NO. SHI. NO.	REVISION